

Product code: LM232 FORP PE

Play Centre ARTHUR



4 y



2.27 m



5.65 m



9.43 m



3.95 m

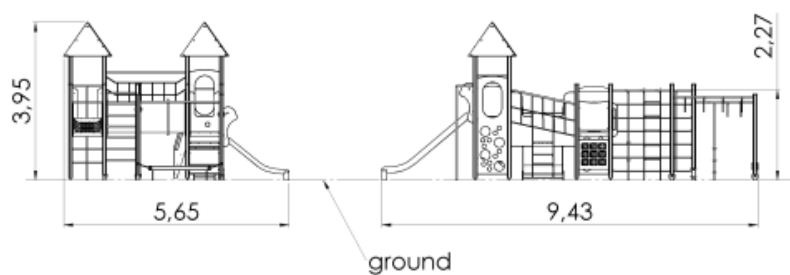
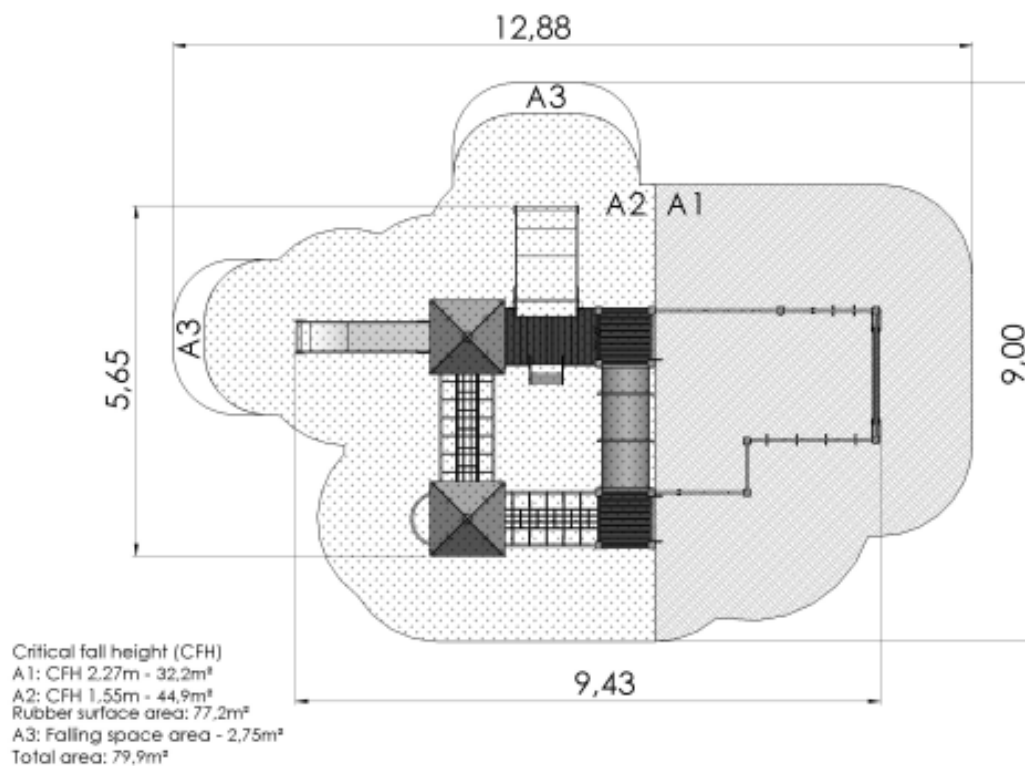
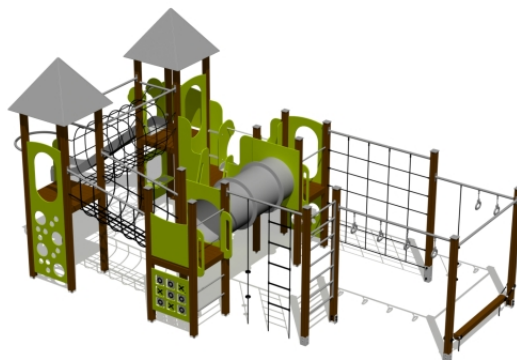

Technical information

Safety area width	9 m
Safety area length	12.88 m
Width of structure	5.65 m
Length of structure	9.43 m
Height of structure	3.95 m
Max. fall height	2.27 m
Recommended age of children	4+
For simultaneous use by several children	1-24

Product consists of

Platforms	2 pcs with a height 1.55 m Plastic covered laminated wood
Platforms	2 pcs with a height 1.2 m Plastic covered laminated wood
Platforms	1 pcs with a height 0.95 m Plastic covered laminated wood
Roofs	2 pcs HDPE plastic
Slides	1 pcs with a height 1.55 m Stainless-steel, HDPE plastic sides
Slides	1 pcs with a height 0.95 m Stainless-steel, HDPE plastic sides
Climbing walls	2 pcs HDPE plastic
Climbing nets	1 pcs 16 mm six-strand PES cover braided steel ropes
Ladders	1 pcs Galvanized and powder-coated steel
Bridges	1 pcs
Tunnels	2 pcs Plastic
Fireman poles	1 pcs Galvanized and powder-coated steel
Play corners	1 pcs Plastic and wood
Activity panels	1 pcs HDPE plastic
Posts	21 pcs Laminated wood
Beams	1 pcs
Panels/Plates	9 pcs HDPE plastic
Grips for hands and/ or feet	11 pcs HDPE plastic
Tubes	19 pcs Galvanized and powder coated steel

Installation info

Installers	2
Installation time	24 h
Volume of concrete	40 bags (25kg)
Package dimensions	2,9x1,3x2,3m

The product's painted profile posts made of laminated timber are concreted into the ground using hot-galvanized metal tubular fittings.

This engaging and versatile climbing and play centre provides a selection of diverse elements for many different activities. The five platforms can be accessed via ladders or climbing walls with holes. A net bridge, a crawl tunnel and a sloping bridge with handrails connect the platforms. A slide and a fireman's pole offer excellent sliding opportunities. An adjoined climbing complex, comprised of a net wall, climbing ropes, monkey bars with handles, a shifting balancing beam, and a vertical ladder, helps develop climbing and dexterity skills. For role playing, the centre is equipped with a Tic-Tac-Toe game and a fun play corner with a bench, which can be fitted with either kitchen or car dashboard elements. The side panels of the play centre can be switched for various activity walls or thematic printed panels (animals, birds, fish, trees, berries, etc.). The design of the panels will be finalised with the client during ordering.